



"We Do Care - We Do More"

# MJM International Corporation

## 418-3TW

### Assembly Instructions

#### IDENTIFY COMPONENTS TO START ASSEMBLY



- ☐ SEAT SECTION FRAME
- ☐ PVC BACKREST WITH MESH SLING.
- ☐ SEAT CUSHION
- ☐ SIDE ADJUSTABLE ARMS WITH FRONT GATE
- ☐ BOX WITH CASTERS AND SCREWS
  - 2 CASTERS WITH BRAKES.
  - 2 CASTERS NON BRAKE.

#### STEP 1 – CASTERS

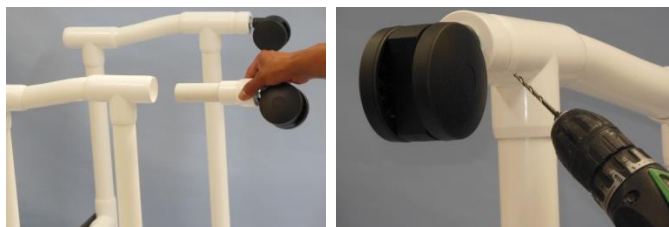

- ☐ INSERT CASTER LEG STEMS INTO BASE SECTION
- ☐ DRILL THROUGH LEG PIPES USING 1/8 DRILL BIT AND PILOT HOLES AS REFERENCE.



- ☐ SECURE CASTERS USING 1/2" RETAINING SCREWS.

**NOTE: A PHILLIPS SCREWDRIVER OR A CORDLESS HAND DRILL IS REQUIRED TO TIGHTEN / SECURE ALL SCREWS.**

#### STEP 2 – ADJUSTABLE ARMS



- ☐ REMOVE SCREWS FROM SEAT SECTION.



- ☐ INSERT ADJUSTABLE ARMS INTO FITTINGS ON SEAT SECTION.



- ☐ SECURE USING 1" RETAINING SCREWS PILOT HOLES AS REFERENCE.

#### STEP 3 – BACKREST & MESH SLING



- ☐ REMOVE SCREWS FROM ADJUSTABLE ARMS.



- ☐ INSERT PVC BACKREST INTO T-FITTING LOCATED ON ARM SECTIONS.



- ☐ SECURE USING 1/2" RETAINING SCREWS AND PILOT HOLES AS REFERENCE.

**NOTE: CASTERS, ARMS, PVC BACKREST MUST BE CHECKED AND SECURED PRIOR TO USING WALKER.**  
**WARNING NOT SECURING ALL THE ABOVE CAN CREATE A SERIOUS SAFETY HAZARD.**

Rev: 1.3



"We Do Care - We Do More"

# MJM International Corporation

## 418-3TW

### Assembly Instructions

#### STEP 4 – SEAT CUSHION



- PLACE SEAT CUSHION ONTO SEAT SUPPORT.

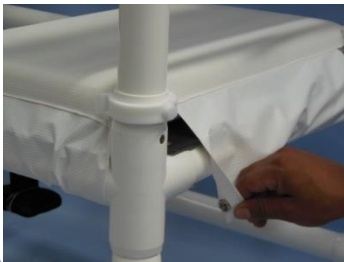

- SECURE SEAT CUSHION WITH SNAPS .

#### STEP 5 – SEAT CUSHION AND FRONT GATE.



- SECURE SEAT CUSHION WITH VELCRO STRAPS.

#### STEP 6 – SAFETY STRAP

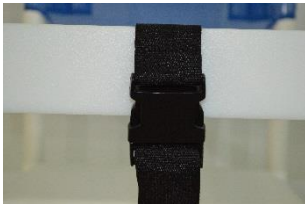

- CLAMP ON FLAT GATE ON FRONT SIDE RAIL.
- SECURE FLAT GATE WITH THE VINYL STRAP.
- SECURE SAFETY BELT.



- PRODUCT COMPLETELY ASSEMBLED



*"We Do Care - We Do More"*

# MJM International Corporation

## CARE INSTRUCTIONS

### ***PVC PIPING AND CASTERS***

Wipe down piping with non-abrasive cleanser. **DO NOT** use solvents. Restore luster with Johnson's Pledge or similar spray wax. If casters are used in wet environment, keep lubricated with white lithium paste or similar lubricant; remove hair and mop- thread build up. Provide a weekly maintenance to avoid premature rusting. Rust Proof or Plastic caster need the same care to get the maximum usage.

### **MESH FABRIC (SLING)**

If laundering is required, use only **COLD** water in large machine, with regular detergent and one-cup bleach. Do not use softeners or solvents. Spin-dry only; machine heat will shrink mesh fabric. Hang damp fabric on frame and allow to air dry, returning to its original shape.

### **SOLID FABRIC (PRIVACY SKIRTS)**

Wipe down panels with sponge using solution of mild detergent, one-cup bleach and three gallons water, **DO NOT** launder in machine. To keep vinyl flexible, occasionally spray with furniture polish (e.g. Pledge) or vinyl formula (Armor All). This will help drying out and cracking.

### ***FOOTREST AND DROP ARMS***

Remove soap build-up from sliding surface; with a soft bristle brush and soapy solution. Lubricate sliding mechanism with furniture spray wax to restore ease in movement.

When lifting drop-arm, use two hands, one at each end of the section. Lifting only at hand grip will put undue pressure against the sliding fitting.

### ***SOFT SEAT***

Wipe with non-abrasive disinfectant wash. Avoid contact with sharp or rough surfaces.

**CAUTION:** **DO NOT** use chair if casters are rusted and fail to move easily or if cracks occur in fittings.

**THE GLOBAL LEADER IN PVC MEDICAL EQUIPMENT!**

323 East Owassa • Suite 4 • Edinburg, TX 78539 • 1-800-270-6199 • 956-781-5000 • Fax 956-781-5552

[www.mjminternational.com](http://www.mjminternational.com) • [hmoroles@yahoo.com](mailto:hmoroles@yahoo.com)

- ☐ CLAMP ON FLAT GATE ON FRONT SIDE RAIL.
- ☐ SECURE FLAT GATE WITH THE VINYL STRAP.