

AMR1AWSV1

Sit Stand Combo Workstation Wall Mount System

This Amer Combo Wall Mount Workstation System provides an ergonomic and convenient method to create work efficiencies and maximum space utilization. Designed with individual arms to hold the display and keyboard tray separately, this sit-stand wall mount system allows for easy collaboration and high flexibility in both function and ease of use.

The Mount system comes with a CPU wall mount holder to allow for the easy storage and accessibility of the main processing unit and a mouse holder to keep the station neat and organized.



Specifications

General

Material:	• Steel/Aluminum Alloy/Plastic
Weight:	• 10.1 kg (22.27 lbs)
KeyBoard Tray	• 2.5 Kg (5.5 lbs)
Support Max Weight:	• 10 Kg (22.1 lbs)
Screw Type:	• M4
Dimension: (W*H*D)	• 581 x 880 x 201 mm 22.87" x 34.65" x 7.91"
Support Flat Panel Size:	• ≤24"
Mounting Pattern:	• 100x100 / 75x75 mm

CPU Holder

Material:	• Steel/Rubber/Plastic
Dimension: (W*H*D)	• 239 x 186 x 220 mm 9.41" x 7.32" x 8.66"
Weight(Net):	• 2.08 Kg (4.59 lbs)
Support Max. Weight:	• 18 Kg (39.7 lbs)

Warranty and Support

Warranty: 3 Years
 Support: Free technical support (phone/email)

AMR1AWSV1

See more • Do more • Be more

Sit Stand Combo Workstation Wall Mount System

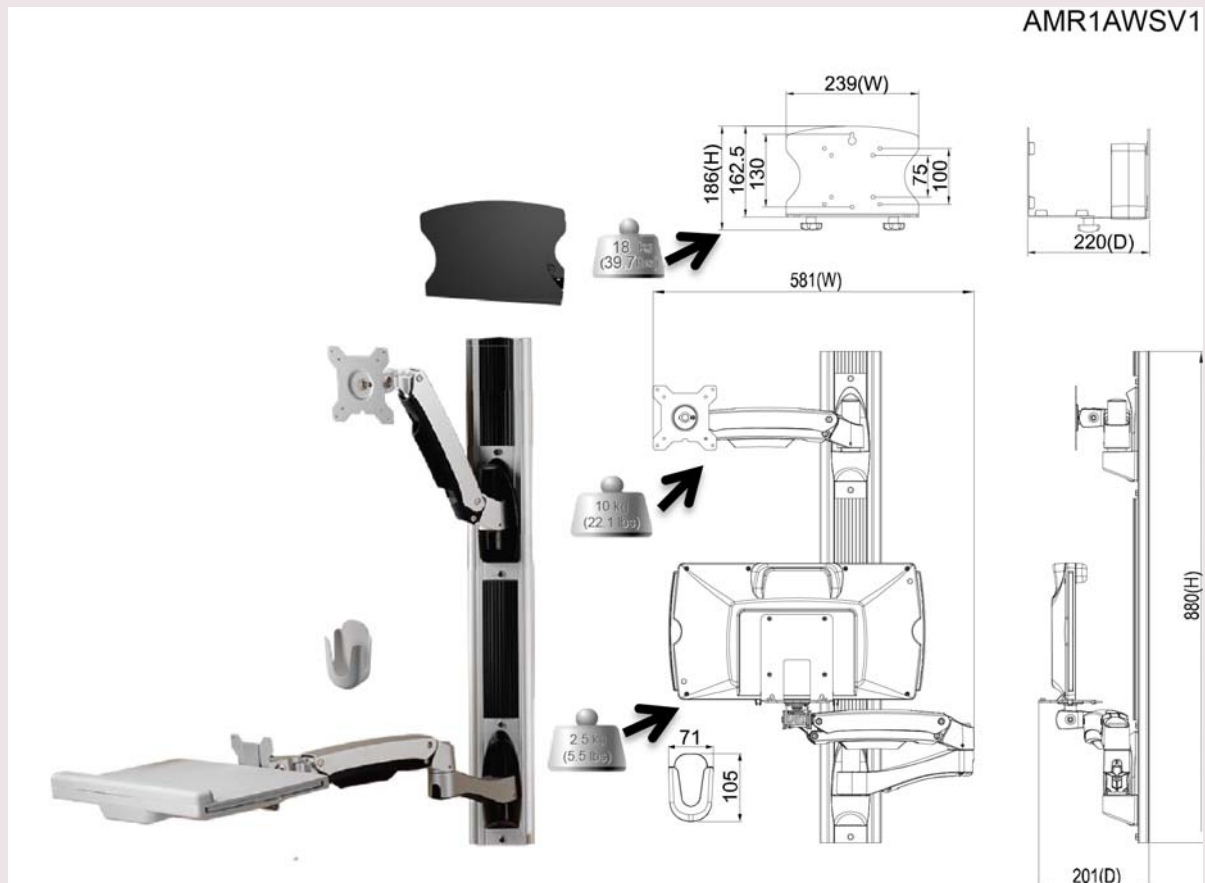

AMR1AWSV1

Sit Stand Combo Workstation Wall Mount System

Keyboard ARM

AMR1AWSV1

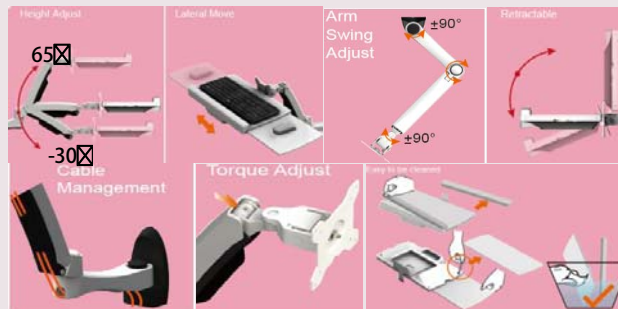
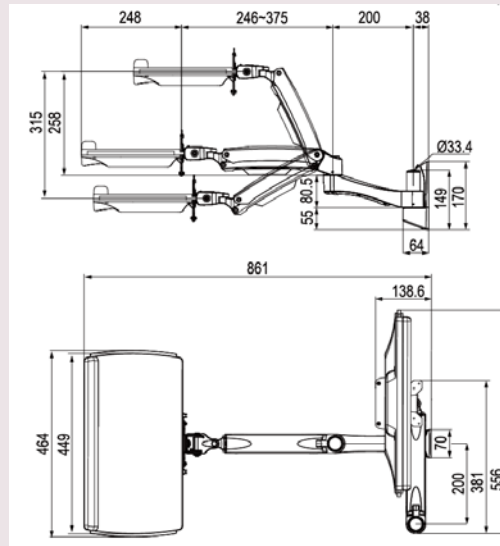

Keyboard Plate

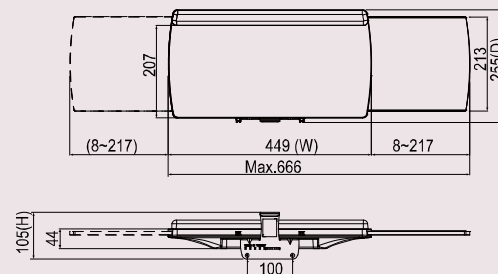

AMR1AWSV1

See more • Do more • Be more

Sit Stand Combo Workstation Wall Mount System

AMR1AWSV1

Monitor ARM

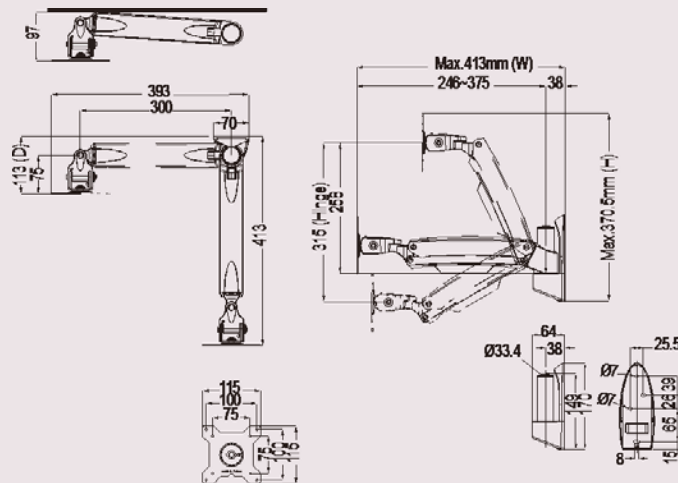

Mouse Holder

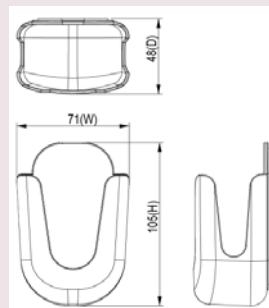

CPU Holder

